

Richmond 293

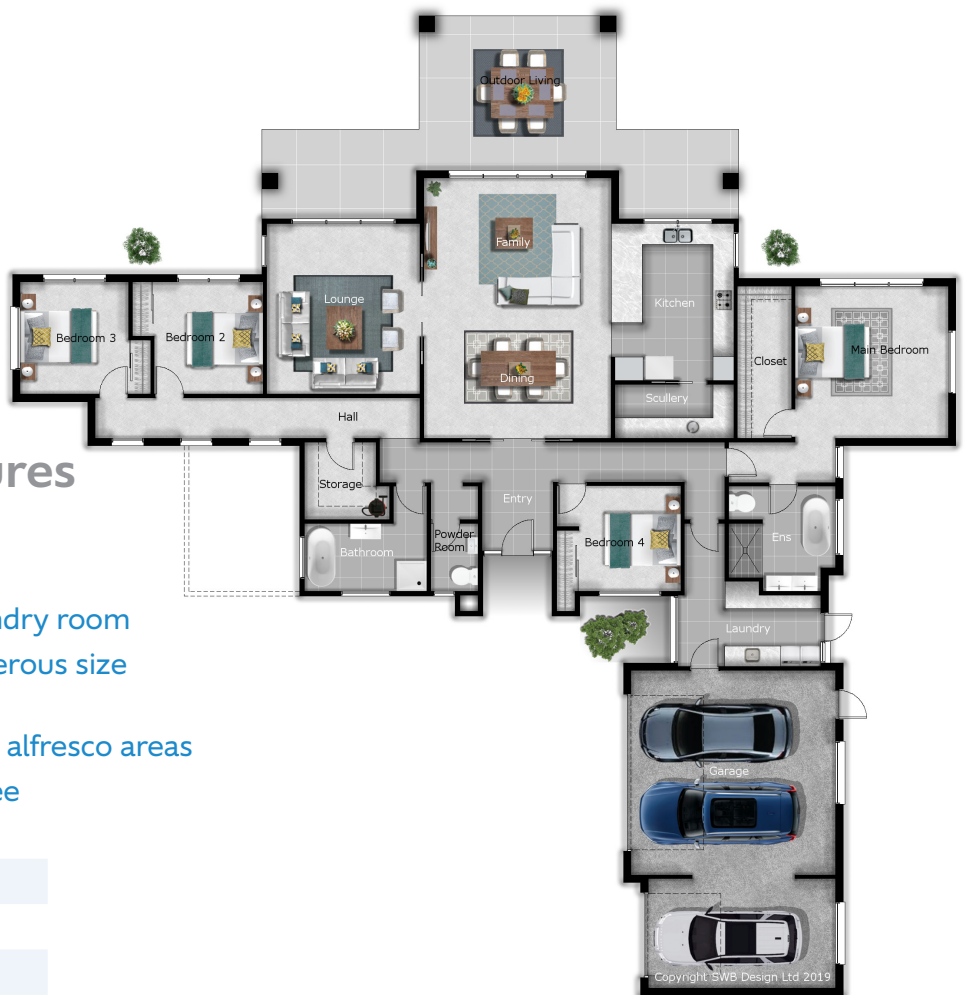

Gable



Richmond 293 features

- European tapware
- Triple car garaging
- Large scullery & separate laundry room
- A large home with 4 very generous size bedrooms and living spaces
- Covered outdoor entertaining alfresco areas
- 10 Year Master Build Guarantee

	Living Areas	2
	Bedrooms	4
	Ensuite	1
	Bathroom	1
	Laundry	1
	Garage	3
	Building Length	27.35m
	Building Width	23.87m
	Price Range	\$700k - \$750k
	Size	293m ²



Gable



affordable family homes with style

Copyright: These designs and illustrations remain the property of Abode Homes Ltd and may not be used or reproduced in whole or in part without written consent.

